

B. A. Construction Services

8 Airport Park Boulevard
Latham, NY 12110
Ph : 518-785-3005

RFI

To: Thomas Field, III
Clark Engineering
20 Shaker Road
New Lebanon, NY 12125
Ph: (518) 794-8613 Fax: (518) 766-5663

RFI #: 1
Date: 4/25/2008
Job: 07-20-2046 Hoosic Valley School
Phone:

CC: Bruce Boice (B.A. Construction Services LLC), Thomas Kenney (CS Arch, P.C.)

Subject: HV01-1 - Score Board Steel

Drawing: CL-106 - 400 Meter Track Layout and
Materials Plan

Spec Section:

Cost Impact: None

Schedule Impact: None

Request:

Date Required: 4/30/2008

On Detail 1 of DWG CL-06, it shows W12 x 40 steel I beam powder coated and cast into concrete base.

- 1) A alternate method would be anchor bolts cast in base with a steel plate welded to base of I beam. This would allow for adjustments/plumbing of supports.
- 2) Also we cannot locate an oven for powdercoating a beam over 26'-0" in length.
- 3) There also would be a cost savings associated for shortening steel beams.
- 4) If you do not elect this please provide a vendor which can powder coat these beams.

Requested by: B.A. Construction Services LLC

Response:

See attached RFI-1 SKI-1 showing an alternate base plate with anchor bolt details. This will be an acceptable installation instead of embedding the column, and modifies Detail 4/S600.

Answered by: Ann Clark
Clark Engineering

Answered date: May 08, 2008

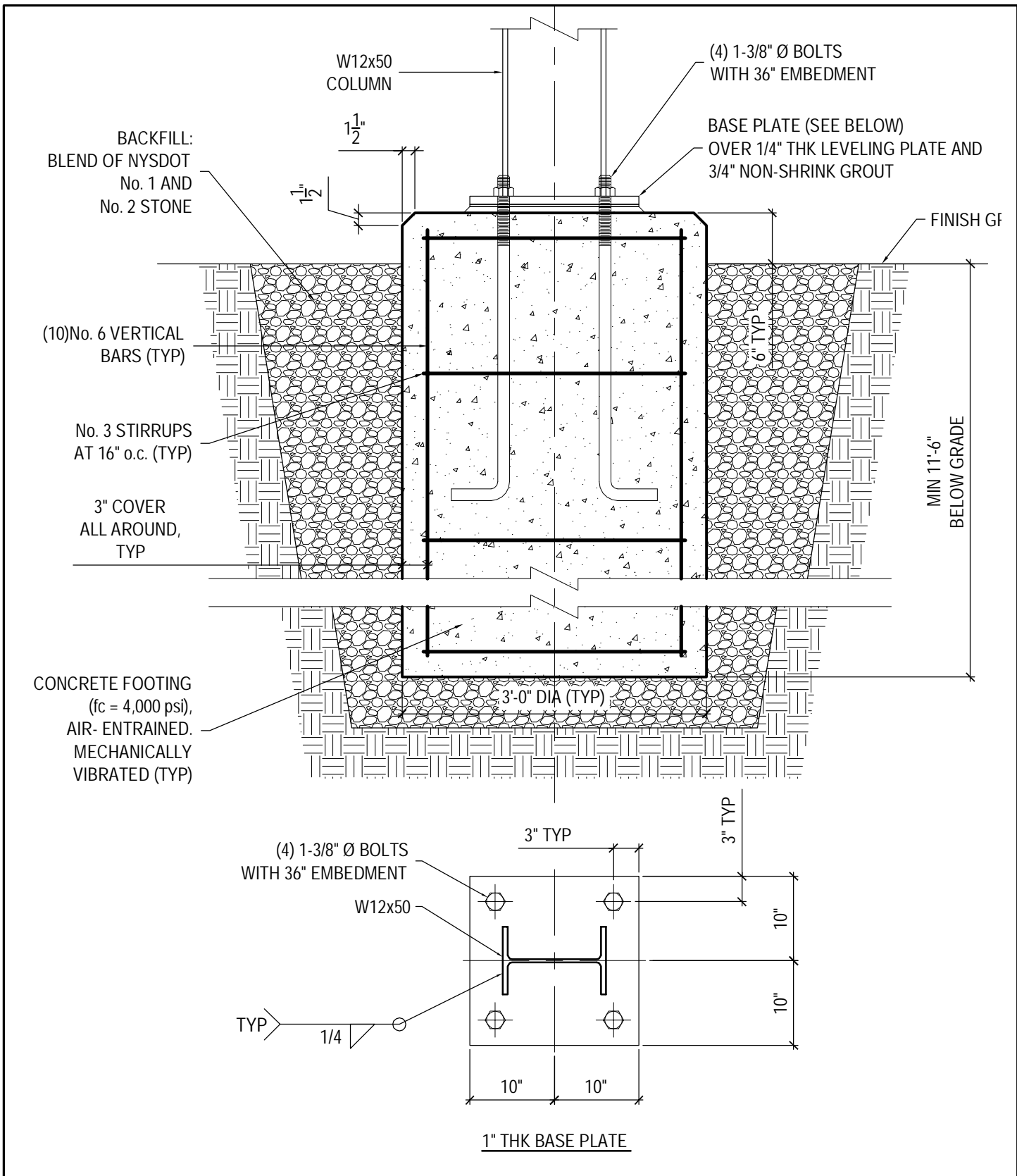

40 Beaver St., Albany, New York 12207-1511
 518.463.8068 FAX 518.463.8069
 www.csarchpc.com

Project: HOOSIC VALLEY CENTRAL SCHOOL DISTRICT
 HOOSIC VALLEY ELEMENTARY SCHOOL

Drawing Title: SCORE BOARD: FOUNDATION DETAIL

Modifies Drawing No.: 4/S600

Scale: 3/4" = 1'-0"

Proj. No.: 49-14-01-04-0-002-013

CSArch No.: 07001.00

Designed By: A.L.C.

Drawn By: L.T.

Checked By:

Date: MAY 6, 2008

Sheet 1 of 1

Drawing No.: RFI -1- SK1